

Schöck Isokorb® T Typ S

T
Typ S

Stahl – Stahl

Einbauanleitung

type S-N

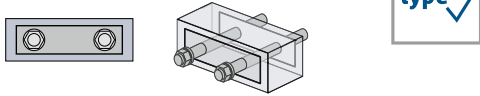

type S-V

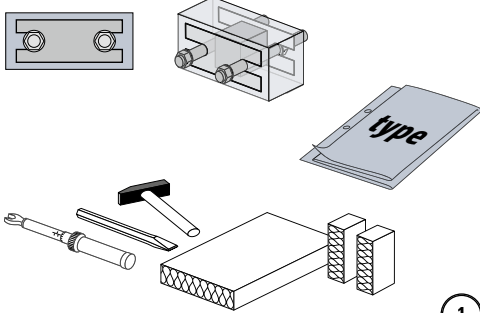

1

Alle Gewinde auf Leichtgängigkeit prüfen. Falls erforderlich, zuerst säubern und schmieren!

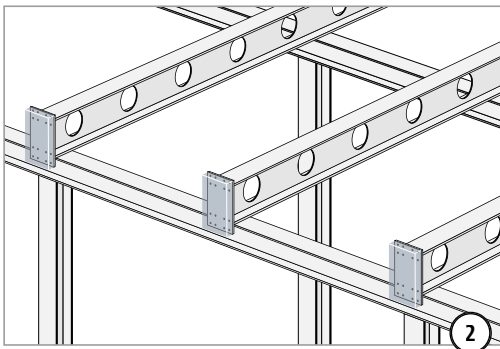

2

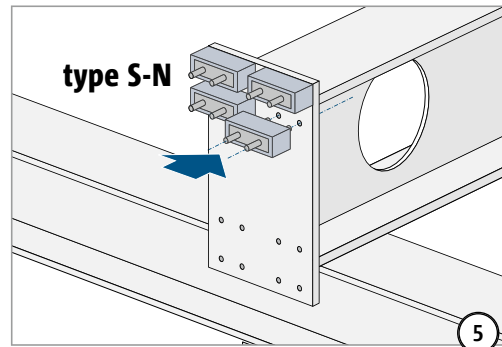

5

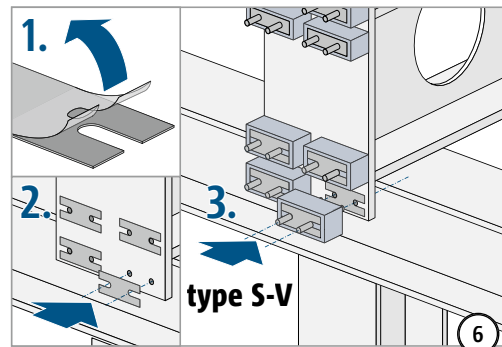

6

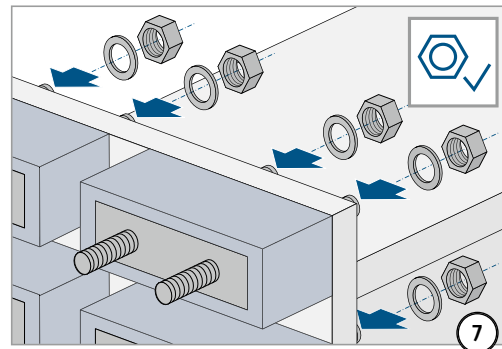

7

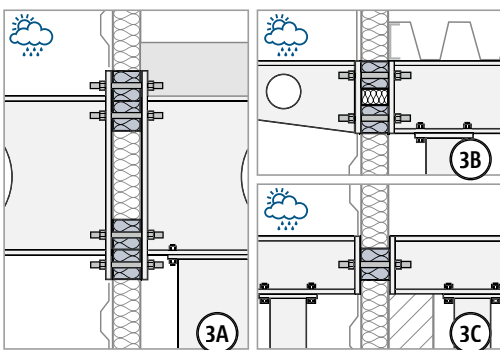

3A

3B

3C

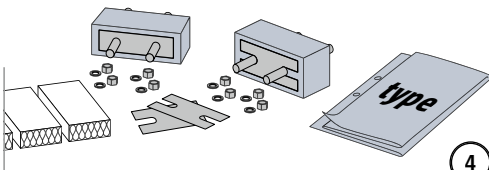

4

type	Zug	Schlüsselweite
S-N-D16	M16	24 mm
S-N-D22	M22	32 mm
S-V-D16	M16	24 mm
S-V-D22	M22	32 mm

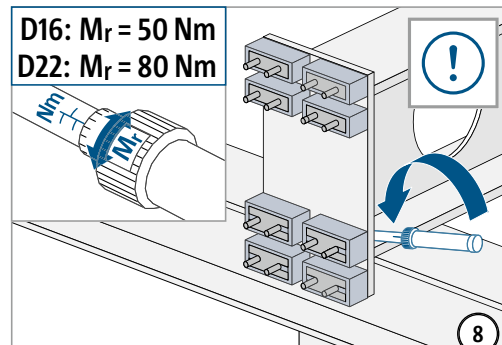

D16: $M_r = 50 \text{ Nm}$
D22: $M_r = 80 \text{ Nm}$

8

T
Typ S

Stahl – Stahl

Einbauanleitung

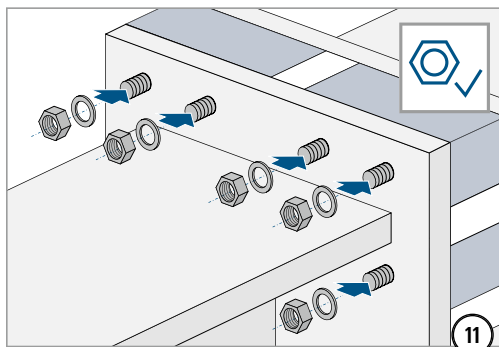
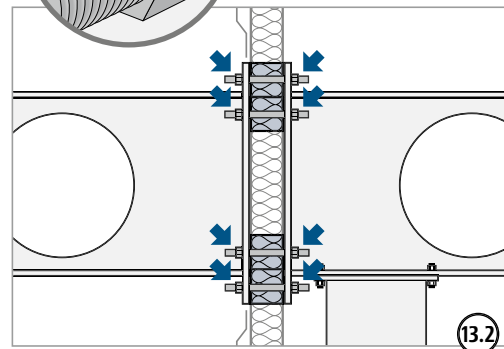
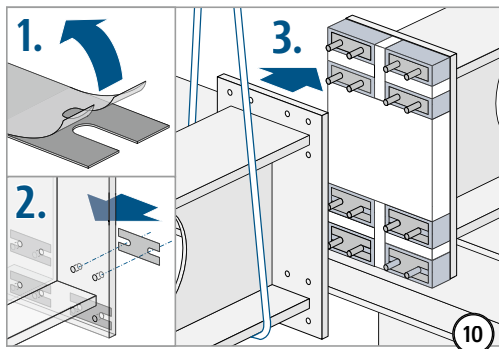
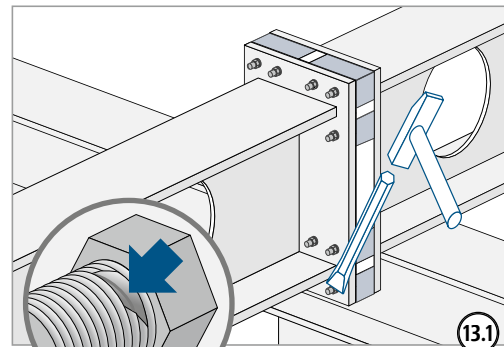
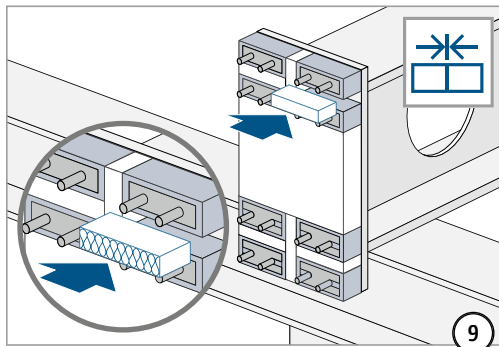

type	Zug/Druck	Schlüsselweite
S-N-D16	M16	24 mm
S-N-D22	M22	32 mm
S-V-D16	M16	24 mm
S-V-D22	M22	32 mm

